

REVISED PLAN

Note/key

The perimeter boundary between the new properties and the existing properties to the north are to have the hedges/fences repaired/reinforced to form 1800mm high fence

- 900mm high natural stone dry stone wall
- - - 900mm high close boarded timber fence
- - - 1800mm high close boarded timber fence
- 1800mm high close boarded timber fence
- mixed variety coniferous/deciduous non-thorn hedge

- Plot 1 semi detached house house type A drawing ref 1531/9
- Plot 2 semi detached house house type B drawing ref 1531/9
- Plot 3/4 semi detached house house type D drawing ref 1531/13
- Plot 5 semi detached house house type A drawing ref 1531/10
- Plot 6 semi detached house house type B drawing ref 1531/9
- Plot 7 detached house house type G drawing ref 1531/17
- Plot 8/9 semi detached house house type E drawing ref 1531/14
- Plot 10 detached house house type H drawing ref 1531/19 & 20
- Plot 11 detached house house type G drawing ref 1531/18
- Plot 12 detached house house type C drawing ref 1531/11
- Plot 13 detached house house type C drawing ref 1531/12
- Plot 14 detached house house type F drawing ref 1531/15 & 16
- Plot 3/4 detached single garage drawing ref 1531/8
- Plot 11/12 combined detached single garage drawing ref 1531/8
- Plot 14 detached carport drawing ref 1531/8

Houses for plots 1, 2, 5 and 6 are local assisted purchase or rented local occupancy properties
Houses for plots 3, 4, 7, 8, 9, 10, 11, 12, 13 and 14 are open market properties

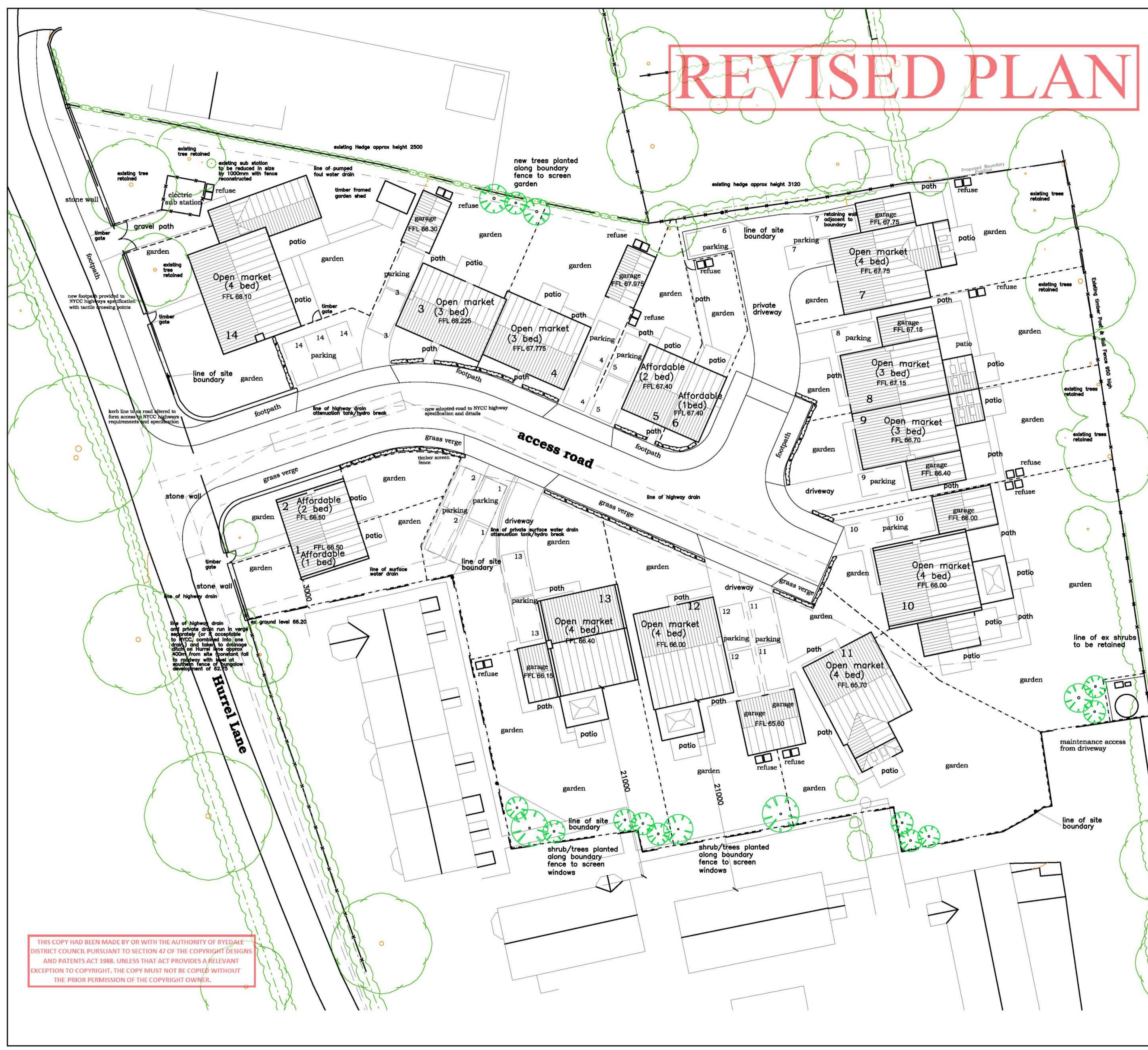
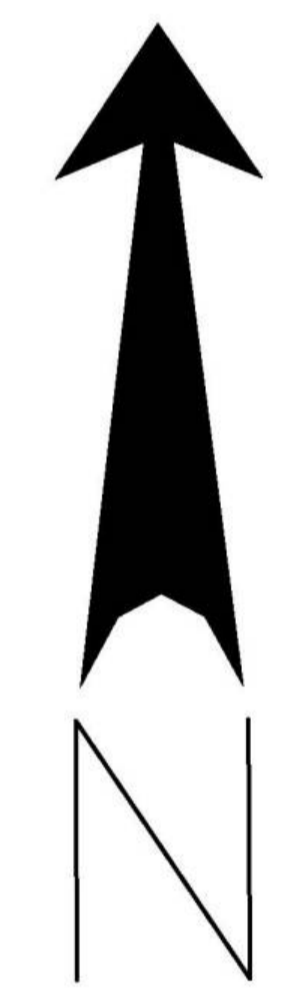

Rev D drainage routes added for private and Highway December 2014
Rev C plot 1, 2, 14 relocated/reassigned November 2014
Rev B plot boundary hedges added/garage relocated November 2014
Rev A plot 8/9 relocated September 2014

THIS COPY HAD BEEN MADE BY OR WITH THE AUTHORITY OF RYedale DISTRICT COUNCIL PURSUANT TO SECTION 47 OF THE COPYRIGHT DESIGNS AND PATENTS ACT 1988. UNLESS THAT ACT PROVIDES A RELEVANT EXCEPTION TO COPYRIGHT, THE COPY MUST NOT BE COPIED WITHOUT THE PRIOR PERMISSION OF THE COPYRIGHT OWNER.

W & W Estates (Thornton Dale) Limited	
Thornton le Dale Care Home Thornton le Dale North Yorkshire YO18 7QR	
proposed site layout	
andrew fletcher MCIAT Architectural Design Consultant	•
147 design limited Packhorse House 51 High Street Stokesley TS9 5AD T: 01642 713300 147design@totalise.co.uk	•
SCALE 1:200 @A1	DRAWING 1531/5D